

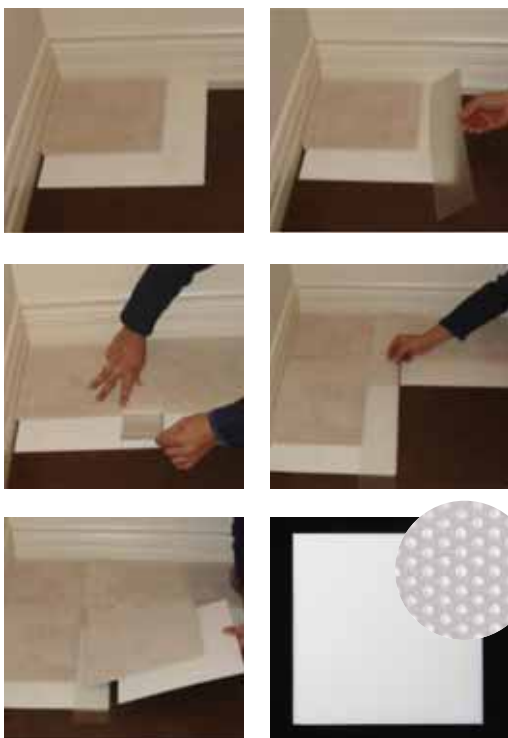

The installation of Senator One-Step Carpet Tiles is accomplished in a “one-step” process as the pre-attached pieces (surface module and hook substrate) are installed simultaneously – making installation quick, clean and easy. The simplicity and flexibility of the installation method makes Senator One-Step™ with TacFast an excellent product line for the Commercial Retail Market. (Below images are a guide for installation).



Senator One-Step Tile

Senator One-Step™ Carpet Tiles with TacFast backing, create a free-floating modular floor that can be installed over any sub floor without any attachment to that sub floor.

Specifications

| | |
|------------------------------------|---|
| Construction | Needle Felt- Plush Velour |
| Fiber Content | 50% Polypropylene, 20% Nylon, 30% Polyester |
| Pile Weight | 28 oz. per s/y |
| Total Weight | 359 oz. per s/y |
| Backing | Bitumen or TacFast with Plates |
| Thickness | .62" |
| Tile size | 19.69" x 19.69" |
| 1 carton | 10 tiles or 27.09 sq.ft. |
| Wear Warranty | 7 years on flat surfaces |
| Electrostatic Propensity | Permanently anti-static |
| Flammability Rating | (See below) |
| Radiant Panel Test - ASTM E648 | Passes federal flamm. standard (Class-1) |
| Pill Test - ASTM D28259 | Pass |
| Hot Metal Nut Test - BS4790/BS5287 | Pass |
| LEED | May contribute towards points, inquire |

